

THE INFORMATION CONTAINED IN THIS DRAWING IS THE SOLE PROPERTY OF L-COM, INC. ANY REPRODUCTION IN PART OR WHOLE WITHOUT THE WRITTEN PERMISSION OF L-COM, INC. IS PROHIBITED.

REVISIONS			
REV	DESCRIPTION	DATE	APPROVED
A	INITIAL RELEASE	6/28/13	D.GRIFFIN
-	-	-	-
-	-	-	-

DESCRIPTION	MATERIAL	FINISH
BODY	BRASS	SILVER
INSULATOR	PTFE	---
CENTER PIN	BeCu	SILVER

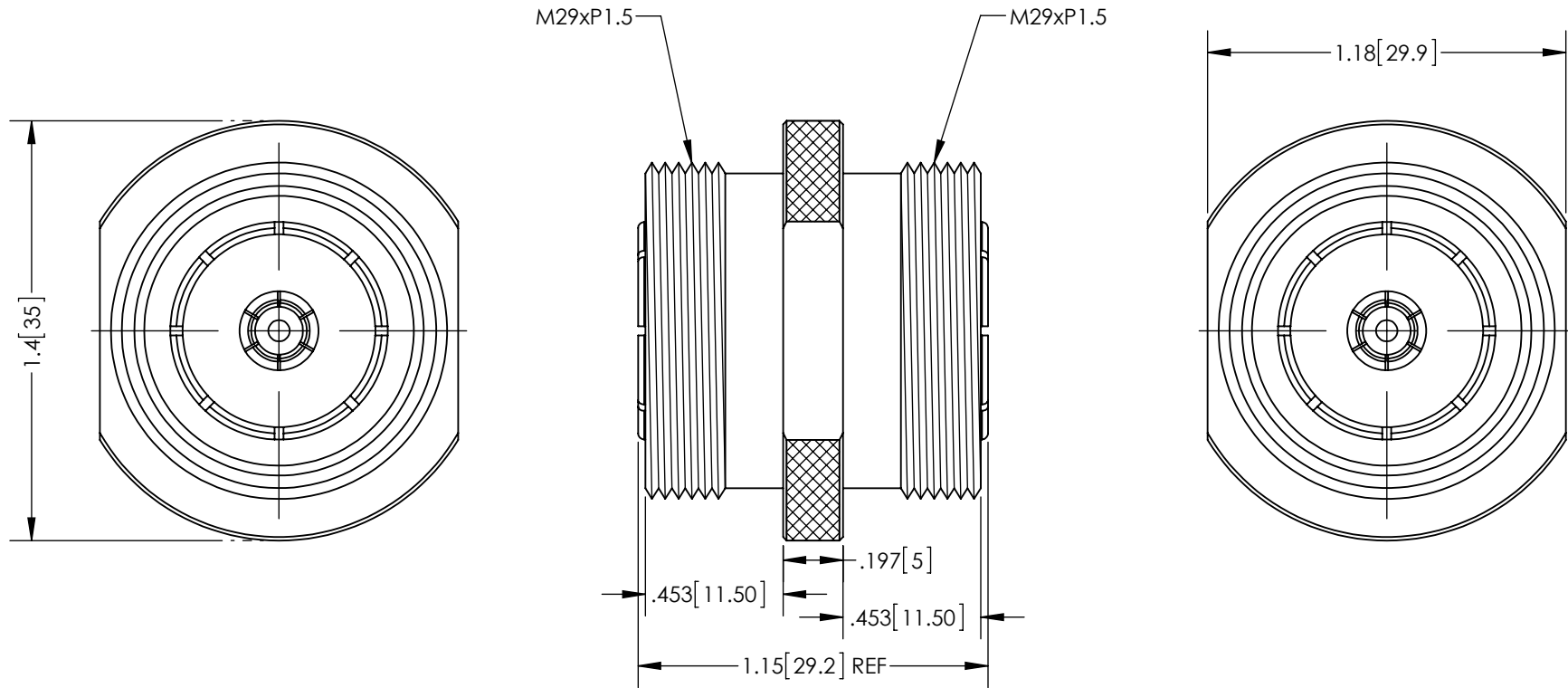

NOTES:

ELECTRICAL:
 IMPEDANCE: 50OHM
 FREQUENCY RANGE: DC~6 GHz
 INSERTION LOSS: .2 dB MAX.
 WORKING VOLTAGE: 2700 VRMS MAX.
 DIELECTRIC WITHSTANDING VOLTAGE: 4000 VRMS MIN.

PACKAGING:
 COMPONENT SHALL BE INDIVIDUALLY PACKAGED IN ACCORDANCE WITH L-COM SPECIFICATION PKG-00012

REGULATORY COMPLIANCE:
 RoHS, CE

UNLESS OTHERWISE SPECIFIED, DIMENSIONS ARE IN INCHES [mm]	APPROVALS	DATE		45 BEECHWOOD DRIVE NORTH ANDOVER, MA 01845
	DRAWN BY B.PUCHASKI	06/27/13		
DIMENSIONAL TOLERANCES: .X = ±.1 .XX = ±.01 .XXX = ±.005	CHECKED BY K.BURGNER	06/27/13	CATEGORY COAXIAL	
	APPROVED BY P.PESA	06/27/13	PRODUCT DESCRIPTION 7/16 DIN FEMALE TO 7/16 DIN FEMALE ADAPTOR	
ANGULAR TOLERANCES: ALL = ± 1°	CONFIGURATION DETAILS OF UNDIMENSIONED FEATURES MAY VARY		SIZE A	FSCM NO. 43321
PROJECTION 	COLOR VARIATIONS MAY OCCUR		DWG. NO. AXA-DFDF	REV. A
SCALE: NONE			CAD FILE: AXA-DFDF.SLDDRW	
				SHEET 1 OF 1